

Marketing Preview



29 Cedar Close, Eckington, Sheffield, S21 4BA

£175,000

Bedrooms 2, Bathrooms 1, Reception Rooms 1



Unique opportunity and viewing is essential. This large two double bedroom semi-detached property has been extended, offering potential to create a third bedroom. It is positioned in a quiet, tucked-away location. The property features three reception rooms and an enclosed garden. It would make an ideal first-time buyer home, with masses of further potential.

SUMMARY

Unique opportunity and viewing is essential. This large two double bedroom semi-detached property has been extended, offering potential to create a third bedroom. It is positioned in a quiet, tucked-away location. The property features three reception rooms and an enclosed garden. It would make an ideal first-time buyer home, with masses of further potential.

The hallway includes an under-stairs storage cupboard. There is a door leading to a large, bright lounge with a front-facing window and access to the inner hallway. The kitchen is positioned to the rear and includes a side door. There is a spacious WC and an extended additional reception room, which could be used as a snug, dining room, or bedroom.

Stairs rise to a spacious landing. There are two large double bedrooms to the front and rear. The bathroom is spacious and includes a bath and walk-in shower. There is also over-stairs storage.

To the front there is shrubbery with a low rise wall. A side path provides access to the front and rear of the property. The rear garden is fully enclosed and features a patio and lawn, along with two brick-built outbuildings.

PROPERTY DETAILS

- FREEHOLD
- FULLY UPVC DOUBLE GLAZED
- GAS BACK BOILER
- COUNCIL TAX BAND A - NORTH EAST DERBYSHIRE COUNCIL

FOR ROOM MEASUREMENTS PLEASE SEE THE FLOORPLAN

Ground Floor

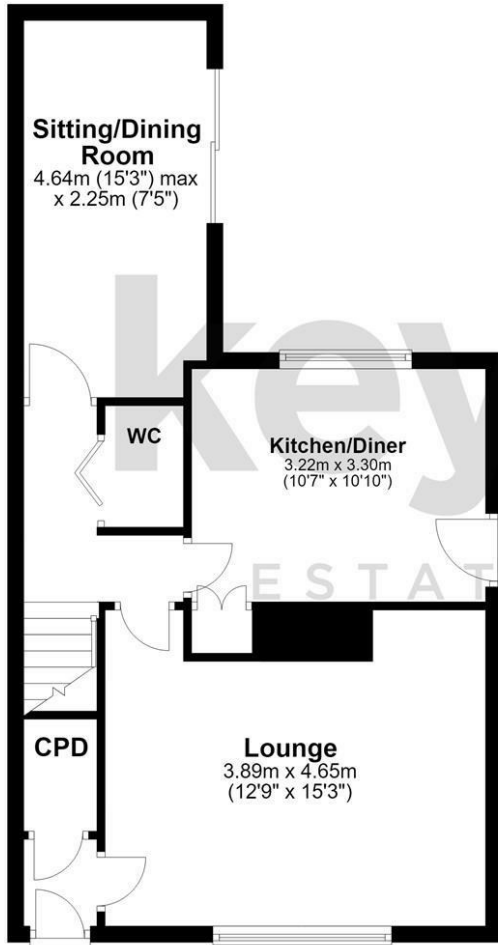

First Floor

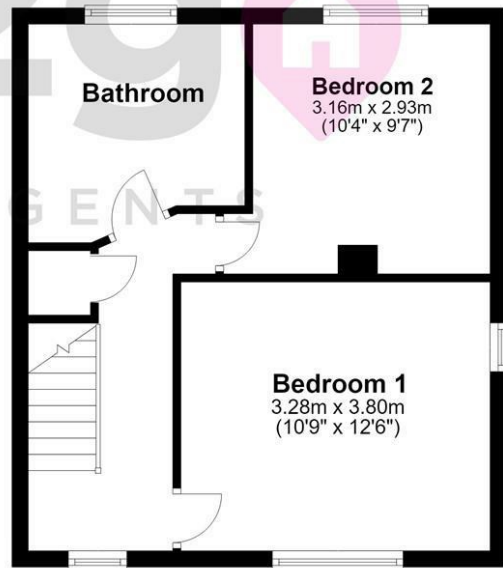

Energy Efficiency Rating

	Current	Potential
<i>Very energy efficient - lower running costs</i>		
(92 plus) A		
(81-91) B		
(69-80) C		
(55-68) D		
(39-54) E		
(21-38) F		
(1-20) G		
<i>Not energy efficient - higher running costs</i>		
England & Wales	EU Directive 2002/91/EC 